

NORTH SOUTH AERIAL VIEW

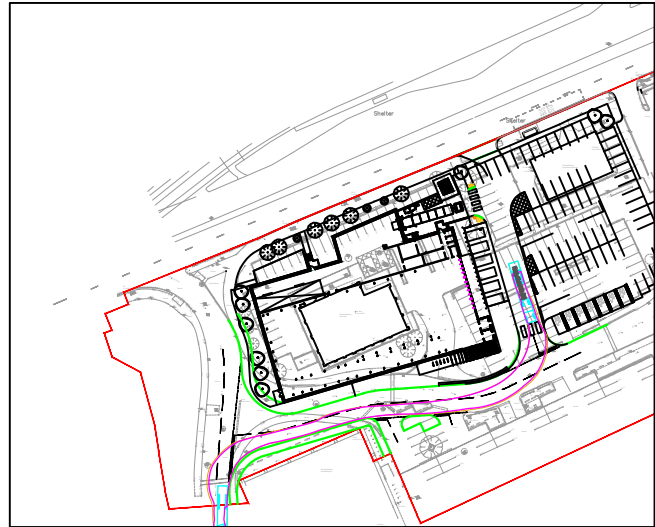

FTA RIGHT OUT OF SITE - SCALE 1:2000@A3

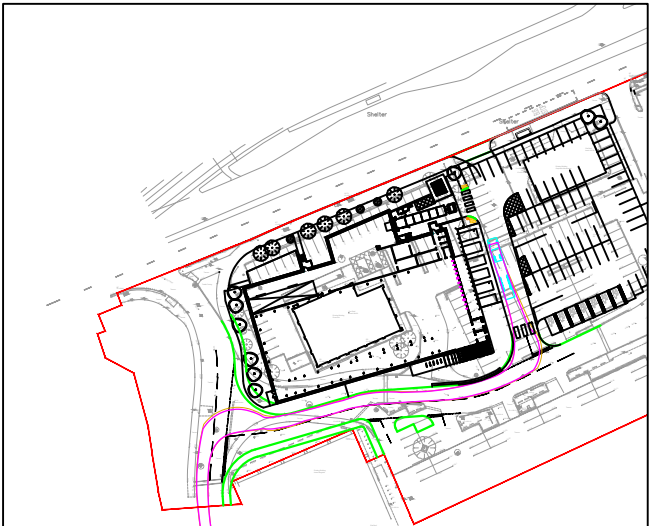

FTA RIGHT INTO SITE - SCALE 1:2000@A3

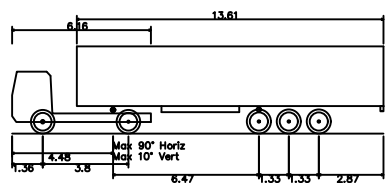

FTA Design Articulated Vehicle (1998)  
 Overall Length 16.480m  
 Overall Width 2.550m  
 Overall Body Height 4.870m  
 Min Body Ground Clearance 0.515m  
 Max Track Width 2.470m  
 Lock to Lock Time 6.00s  
 Kerb to Kerb Turning Radius 6.550m

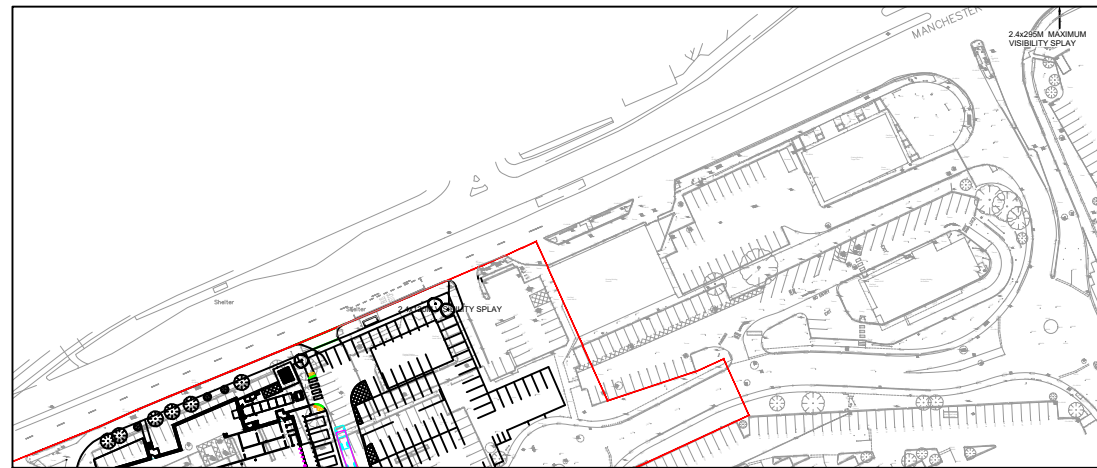

2.4x295M MAX VISIBILITY SPLAY

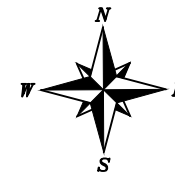
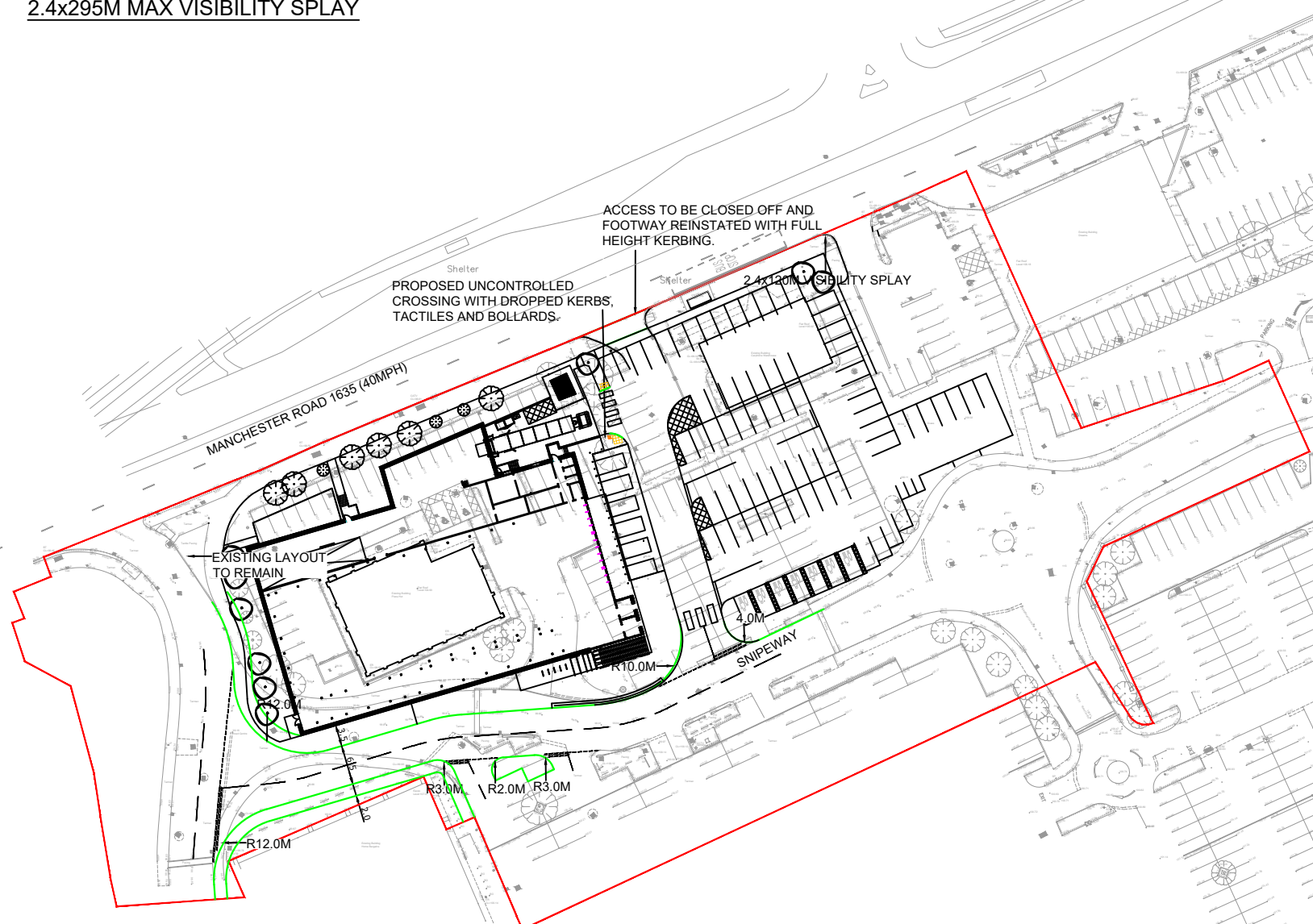

**NOTES**

THIS IS NOT A CONSTRUCTION DRAWING AND IS FOR INDICATIVE PURPOSES ONLY. THE DRAWING WILL BE SUBJECT TO CHANGE FOLLOWING LOCAL AUTHORITY REVIEW AND CONFIRMATION OF PUBLIC HIGHWAY AND THIRD PARTY LAND BOUNDARIES.

- INDICATIVE SITE BOUNDARY
- DENOTES NEW KERBS
- EXISTING ADOPTED HIGHWAY

REV	DETAILS	DRAWN	CHECKED	DATE
E	ACCESS AMENDMENTS	LB	LW	DEC 21
D	VISIBILITY AMENDMENTS	LB	LW	NOV 21
C	MINOR AMENDMENT	LB	JC	JUL 21
B	MINOR AMENDMENT	LB	JC	JUL 21
A	MINOR AMENDMENT	LB	JC	MAY 21

CLIENT:  
**ORCHARD STREET**

PROJECT:  
**SHIPE RETAIL PARK,  
 ASHTON UNDER LYNE**

DRAWING TITLE:  
**PROPOSED SITE ACCESS  
 ARRANGEMENT**

SCALES:  
**1:1000 @ A3**

DRAWN: LB    CHECKED: JC    DATE: NOV 20

Croft Transport Planning & Design  
 340 Deansgate  
 Manchester  
 M3 4LY  
 Email: [info@crofts.co.uk](mailto:info@crofts.co.uk)  
 Tel: 0161 837 7380  
 Web: [www.eddisons.com/services/transport-planning](http://www.eddisons.com/services/transport-planning)

DRAWING NUMBER: **2181-F02**    REVISION: **E**

